

# The COLEBROOK - 30' x 40'

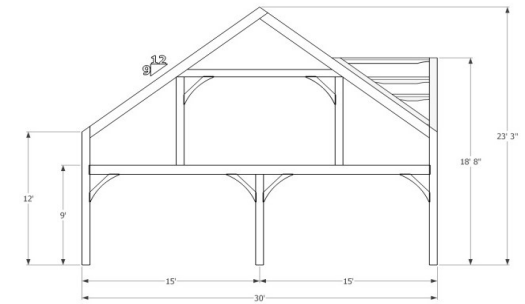

Bent View

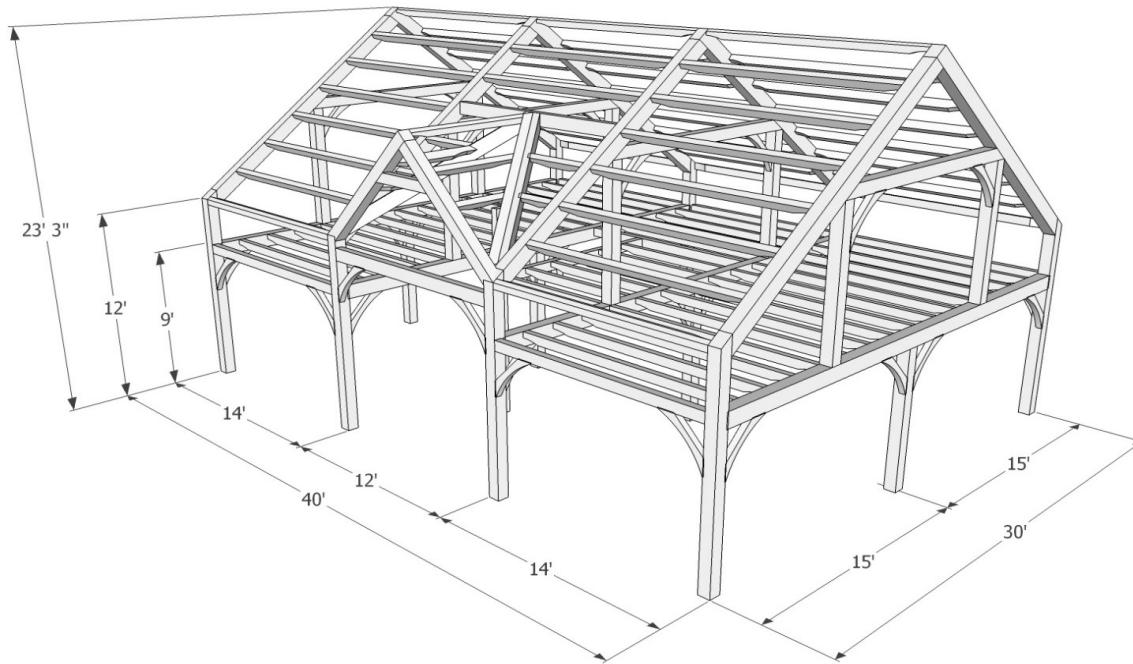
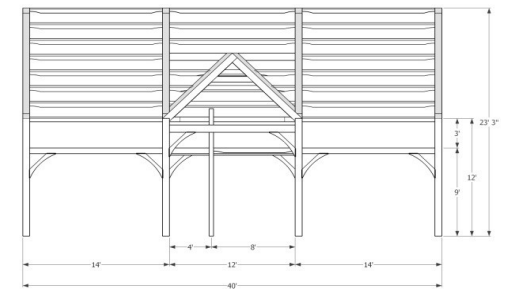

Side View

This Ontario Cottage style timber frame is a classic in style and size. With great proportions this time tested frame will make a lovely home or cottage. A gable dormer over the front entry adds a traditional accent and brings more natural light to the upper floor. The footprint is 1,200 ft<sup>2</sup> with ample loft space giving a total living area of 2,256 ft<sup>2</sup>.

	<u><i>E. White Pine</i></u>	<u><i>Douglas Fir FoHC</i></u>	
<i>Shop Work &amp; Design:</i>	\$68,830.00	\$85,065.00	
<u><i>Delivery &amp; Installation starting at*:</i></u>	<u>\$30,730.00</u>	<u>\$30,730.00</u>	
<b>Total:</b>	<b>\$99,560.00</b>	<b>\$115,795.00</b>	+hst

+Add optional V-Joint decking installed on ceilings & lofts: please contact us for details and pricing

<u><i>Details:</i></u>	
<i>Sanding of timbers:</i>	Yes
<i>Clear oil based stain:</i>	Yes
<i>Engineering of timber work:</i>	Yes
<i>Timber frame footprint (sq.ft.)</i>	1,200.0
<i>Total living space w/ loft (sq. ft.)</i>	2,256.0



1948 Sharpe's Lane, Brockville, ON K6V 5T1  
 Office: (613) 498-2406 / Cell: (613) 803-3241  
[www.gibson timber frames.com](http://www.gibson timber frames.com)  
[info@gibson timber frames.com](mailto:info@gibson timber frames.com)

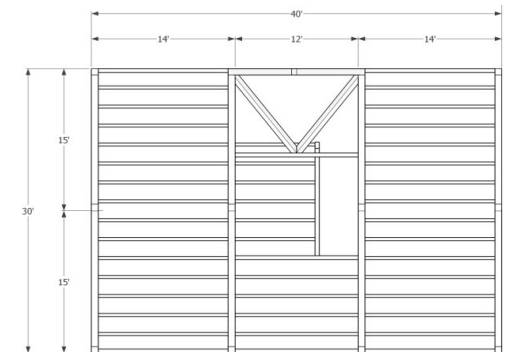

Plan View

\* Within 100km of our shop. Delivery and Installation costs may increase at greater distances.

^ Please contact us for details and current pricing.