

The PETWORTH Series - 28' x 32'

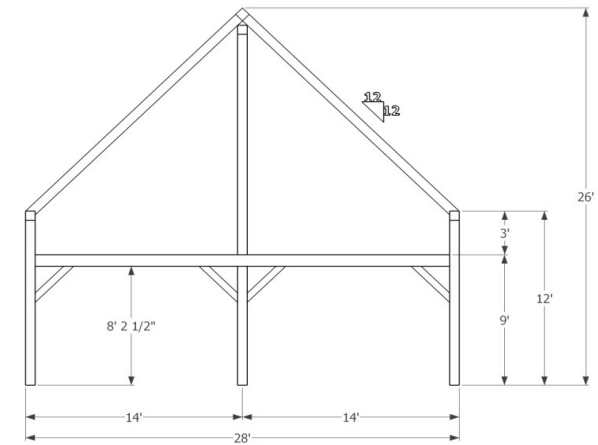

Bent View

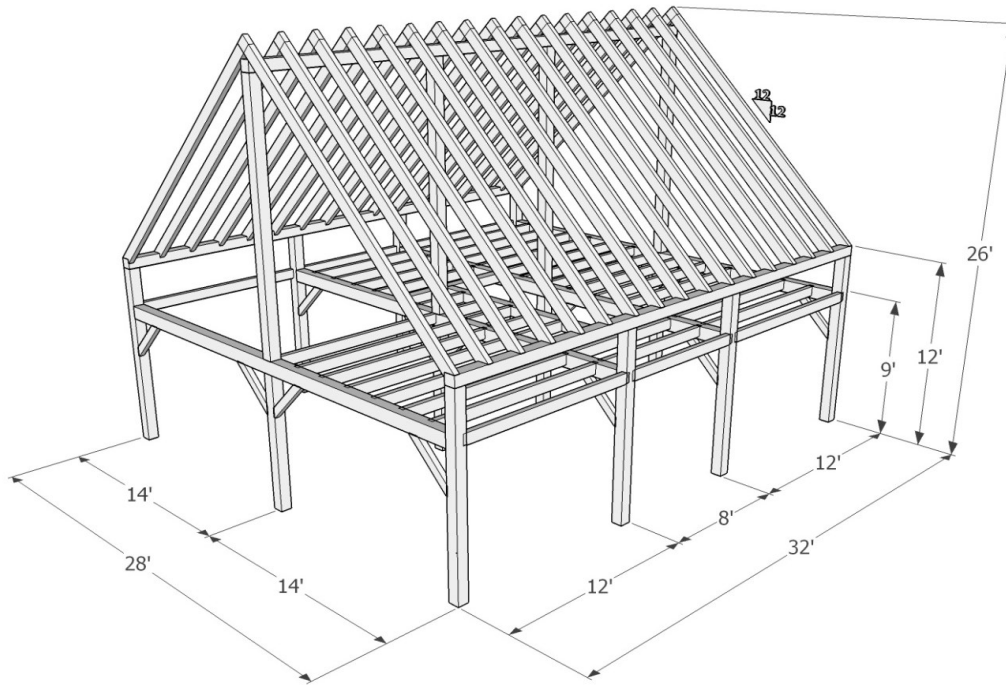
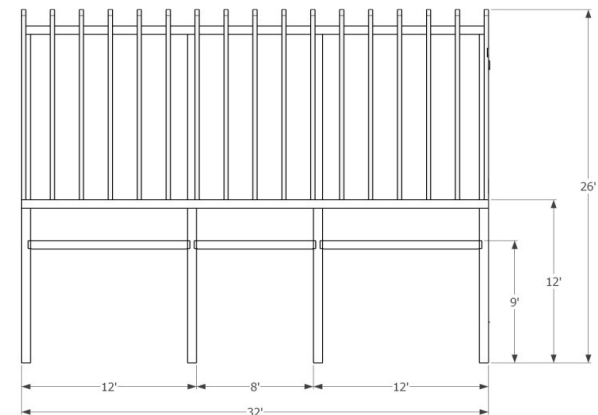

Side View

This lovely timber frame design has a great loft, and makes good use of space with an 896 ft² footprint. With plenty of loft space, the total living space = 1,550 ft². It could be a complete house, cottage, or built as part of a hybrid house project. It can also be built with optional dormers to bring more natural light into the upper floor.

	<u><i>E. White Pine</i></u>	<u><i>Douglas Fir FoHC</i></u>	
<i>Shop Work & Design:</i>	\$47,860.00	\$60,220.00	
<i>Delivery & Installation starting at*:</i>	\$21,615.00	\$21,615.00	
Total:	\$69,475.00	\$81,835.00	+hst

+Add optional V-Joint decking installed on ceilings & lofts: please contact us for details and pricing

Details:

Sanding of timbers:	Yes
Clear oil based stain:	Yes
Engineering of timber work:	Yes
Timber frame footprint (sq.ft.)	896.0
Total living space w/ loft (sq. ft.)	1,550.0



1948 Sharpe's Lane, Brockville, ON K6V 5T1
 Office: (613) 498-2406 / Cell: (613) 803-3241
www.gibson timber frames.com
info@gibson timber frames.com

* Within 100km of our shop. Delivery and Installation costs may increase at greater distances.

^ Please contact us for details and current pricing.