

The PETWORTH Series - 28' x 32' with 4 DORMER Option

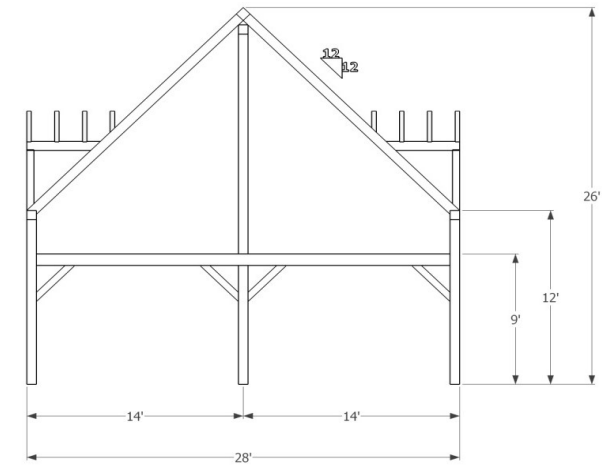

Bent View

This lovely timber frame design has a great loft, and makes good use of space with an 896 ft² footprint. With plenty of loft space, total living space = 1,550 ft². It could be a complete house, cottage, or built as part of a hybrid house project. Here it is shown with 4 dormers that bring more natural light into the upper floor loft.

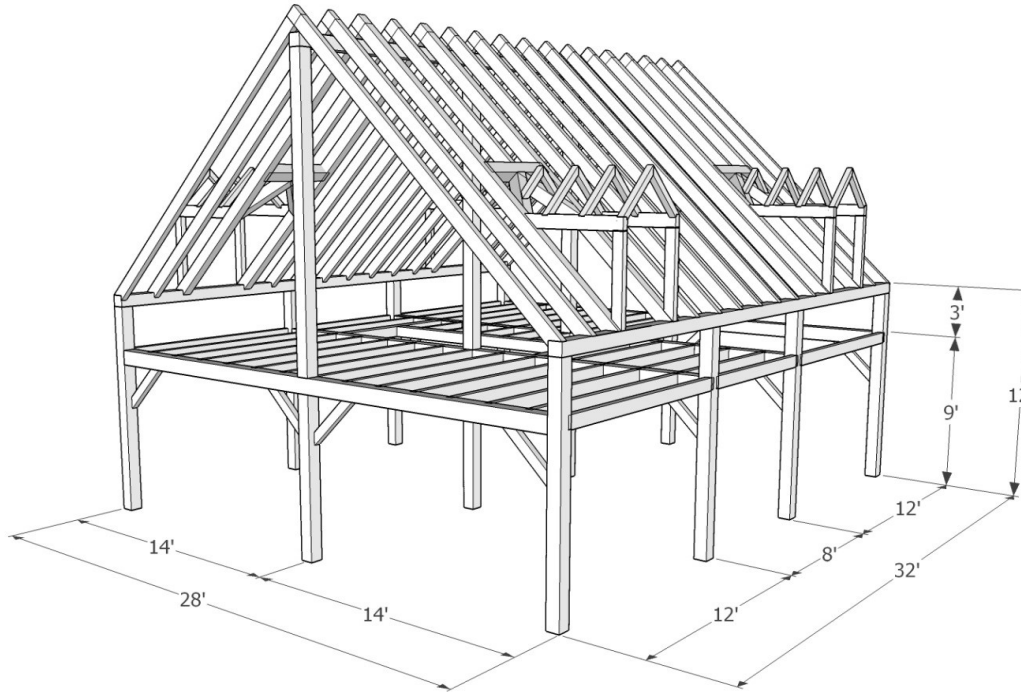

Artist Conception

| | <u><i>E. White Pine</i></u> | <u><i>Douglas Fir FoHC</i></u> | |
|--|-----------------------------|--------------------------------|------|
| <i>Shop Work & Design:</i> | \$63,170.00 | \$77,195.00 | |
| <i>Delivery & Installation starting at*:</i> | \$31,135.00 | \$31,135.00 | |
| Total: | \$94,305.00 | \$108,330.00 | +hst |

+Add optional V-Joint decking installed on ceilings & lofts: please contact us for details and pricing

| <u>Details:</u> | |
|--------------------------------------|---------|
| Sanding of timbers: | Yes |
| Clear oil based stain: | Yes |
| Engineering of timber work: | Yes |
| Timber frame footprint (sq.ft.) | 896.0 |
| Total living space w/ loft (sq. ft.) | 1,550.0 |



1948 Sharpe's Lane, Brockville, ON K6V 5T1
 Office: (613) 498-2406 / Cell: (613) 803-3241
www.gibson timber frames.com
info@gibson timber frames.com

* Within 100km of our shop. Delivery and Installation costs may increase at greater distances.

^ Please contact us for details and current pricing.