

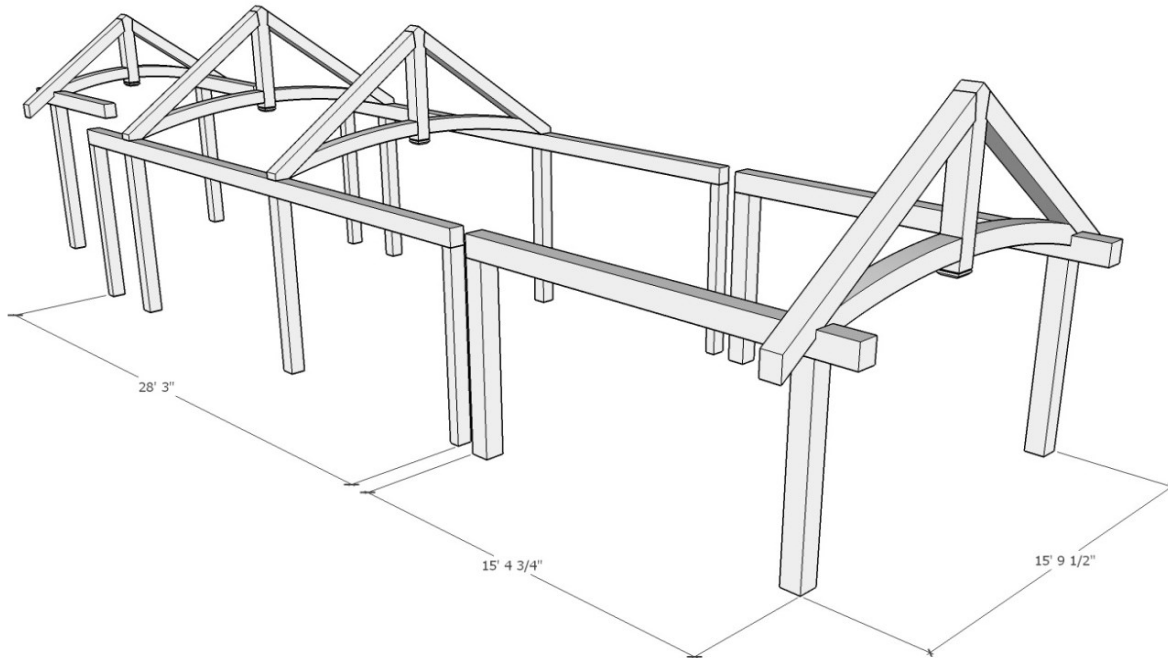

1948 Sharpe's Lane, Brockville, ON K6V 5T1  
 Office: (613) 498-2406 / Cell: (613) 803-3241  
[www.gibson timber frames.com](http://www.gibson timber frames.com)  
[info@gibson timber frames.com](mailto:info@gibson timber frames.com)

**Project:** Great Room, Front & Back Porch Arched Trusses  
**Location:** Kingston, ON  
**Original estimate date:** April 2022

	<u><i>E. White Pine</i></u>	<u><i>Douglas Fir (FoHC)</i></u>	
<i>Shop Work &amp; Design:</i>	\$30,665.00	\$37,470.00	
<u><i>Delivery &amp; Installation:</i></u>	<u>\$15,625.00</u>	<u>\$15,625.00</u>	
<b><i>Total:</i></b>	<b><i>\$46,290.00</i></b>	<b><i>\$53,095.00</i></b>	<i>+hst</i>



<u><i>Decking installed on the ceilings:</i></u>	<u><i>\$7,870.00</i></u>	<u><i>\$9,565.00</i></u>	
<b><i>Total with Decking:</i></b>	<b><i>\$54,160.00</i></b>	<b><i>\$62,660.00</i></b>	<i>+hst</i>

<u><i>Details:</i></u>	
<i>Sanding of timbers:</i>	Yes
<i>Clear oil based stain:</i>	Yes
<i>Engineering of timber work:</i>	Yes
<i>Timber frame footprint (sq. ft.)</i>	440.0
<i>Total living space w/ porches (sq. ft.)</i>	746.0

\* Please contact us for current pricing.