

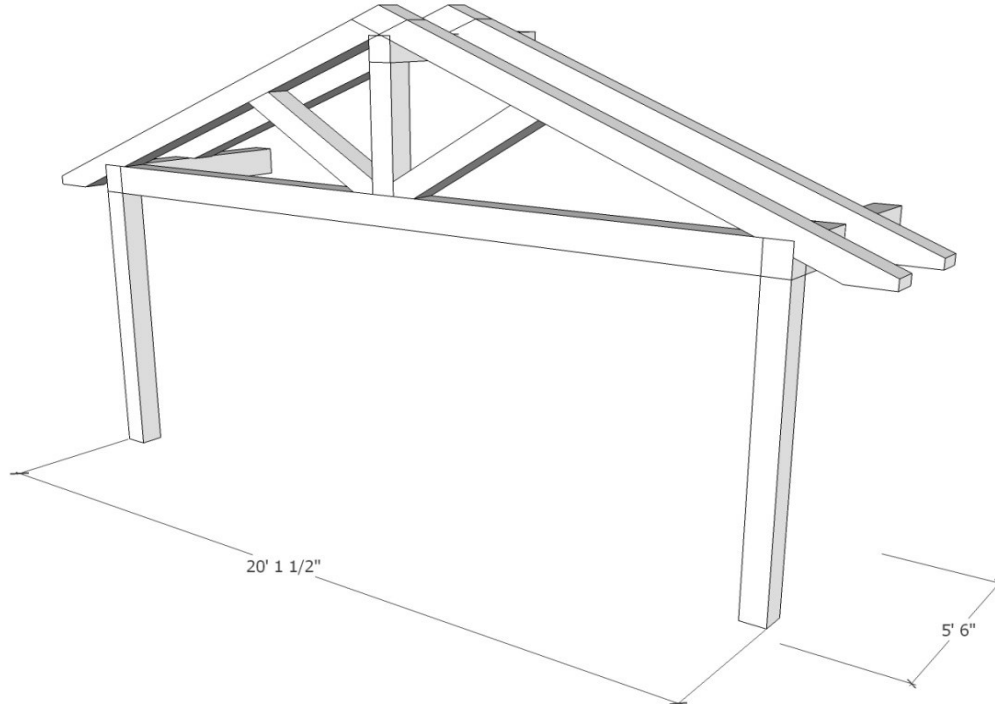

1948 Sharpe's Lane, Brockville, ON
 Office: (613) 498-2406 / Cell: (613) 803-3241
www.gibson timber frames.com
info@gibson timber frames.com

Project: 5'-6" x 20' Front Porch Addition
Location: Kingston, ON
Original estimate date: June 2021

| | <u>E. White Pine</u> | <u>W. Douglas Fir</u> | |
|-------------------------------------|-----------------------------|------------------------------|------|
| <i>Shop Work & Design:</i> | \$8,680.00 | \$10,380.00 | |
| <i>Delivery & Installation:</i> | \$4,795.00 | \$4,795.00 | |
| Total: | \$13,475.00 | \$15,175.00 | +hst |



| | | | |
|---|--------------------|--------------------|------|
| <u><i>Add decking installed on the ceiling:</i></u> | <u>\$2,150.00</u> | <u>\$2,185.00</u> | |
| Total with Decking | \$15,625.00 | \$17,360.00 | +hst |

Details:

| | |
|---------------------------------|-------|
| Sanding of timbers: | Yes |
| Clear oil based stain: | Yes |
| Engineering of timber work: | No |
| Timber frame footprint (sq.ft.) | 115.5 |

* Please contact us for current pricing.

5' x 20' Front Porch_2020ial.xlsx