



1948 Sharpe's Lane, Brockville, ON K6V 5T1
Office: (613) 498-2406 / Cell: (613) 803-3241

www.gibson timber frames.com
info@gibson timber frames.com

Project: 48' x 12' Pool Cabana w/ King Post Truss
Location: Brockville, ON
Original estimate date: April 2023

	<u><i>E. White Pine</i></u>	<u><i>Douglas Fir FoHC</i></u>	
<i>Shop Work & Design:</i>	\$63,875.00	\$74,335.00	
<u><i>Delivery & Installation:</i></u>	<u>\$30,255.00</u>	<u>\$30,255.00</u>	
<i>Total:</i>	<i>\$94,130.00</i>	<i>\$104,590.00</i>	<i>+hst</i>

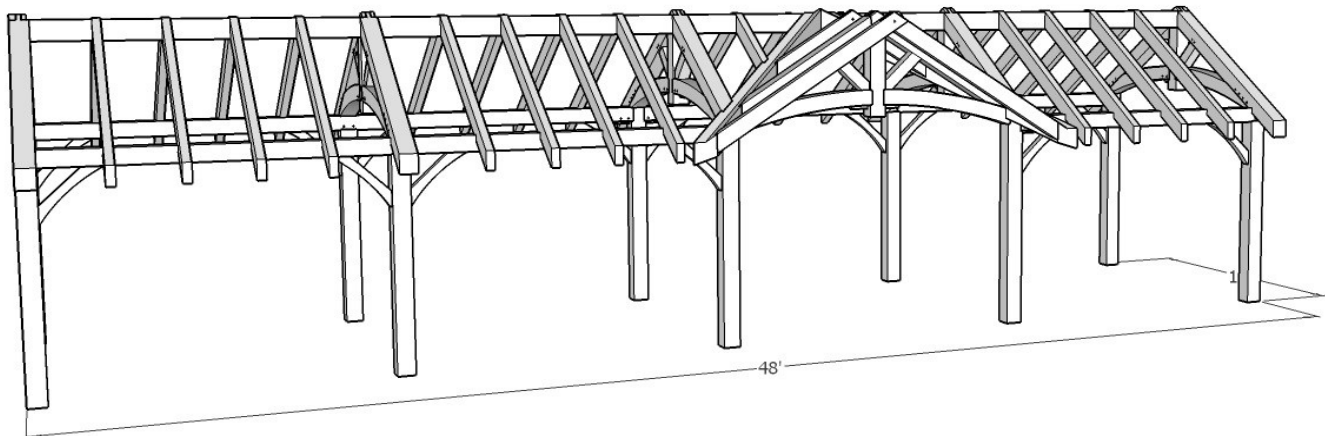

<u><i>Decking installed on ceilings/lofts:</i></u>	<u><i>\$16,685.00</i></u>	<u><i>\$19,535.00</i></u>	
<i>Total with Decking:</i>	<i>\$110,815.00</i>	<i>\$124,125.00</i>	<i>+hst</i>

Details:

Sanding of timbers:	Yes
Clear oil based stain:	Yes
Engineering of timber work:	Yes
Timber frame footprint (sq.ft.)	576.0

* Please contact us for current pricing.

48' x 12' Pool Cabana with King Truss_2023dra.xlsx