

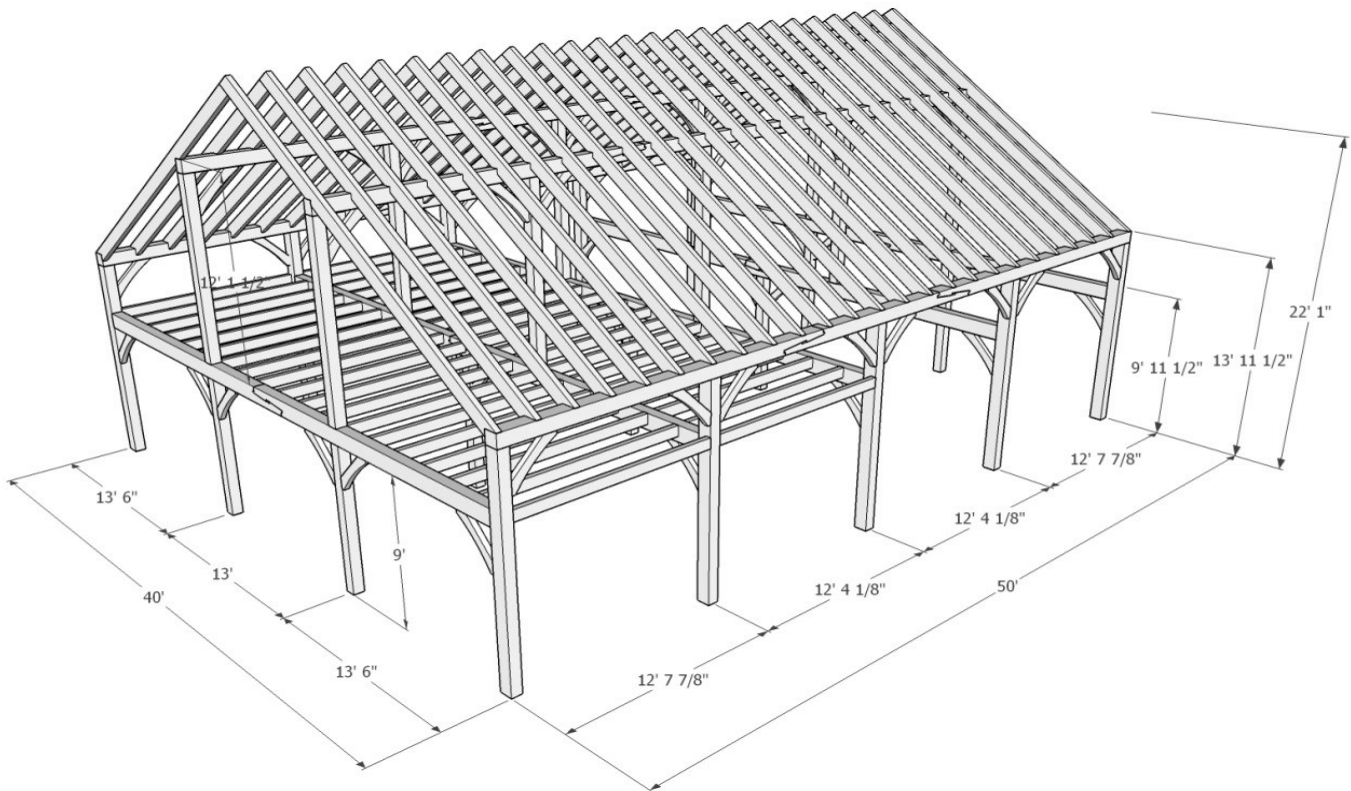

1948 Sharpe's Lane, Brockville, ON K6V 5T1
 Office: (613) 498-2406 / Cell: (613) 803-3241
www.gibson timber frames.com
info@gibson timber frames.com

Project: 40' x 50' Queen Post Barn / Warehouse
Location: Lanark County, ON
Original estimate date: February 2020

| | <u>Eastern White Pine</u> | <u>Western Douglas Fir</u> | |
|-------------------------------------|----------------------------------|-----------------------------------|------|
| <u>Shop Work & Design:</u> | \$85,205.00 | \$114,645.00 | |
| <u>Delivery & Installation:</u> | \$40,830.00 | \$40,830.00 | |
| Total: | \$126,035.00 | \$155,475.00 | +hst |



Details:

| | |
|--------------------------------------|---------|
| Sanding of timbers: | Yes |
| Clear oil based stain: | Yes |
| Engineering of timber work: | Yes |
| Timber frame footprint (sq.ft.) | 2,000.0 |
| Total living space w/ loft (sq. ft.) | 2,950.0 |

* Please contact us for current pricing.