



1948 Sharpe's Lane, Brockville, ON K6V 5T1

Office: (613) 498-2406 / Cell: (613) 803-3241

[www.gibson timber frames.com](http://www.gibson timber frames.com)

[info@gibson timber frames.com](mailto:info@gibson timber frames.com)

**Project:** 31' x 7' Covered Front Porch w/ Arched Truss  
**Location:** Brockville, ON  
**Original estimate date:** February 2020

	<u><i>E. White Pine</i></u>	<u><i>Douglas Fir FoHC</i></u>	
<u>Shop Work &amp; Design:</u>	\$14,285.00	\$18,220.00	
<u>Delivery &amp; Installation:</u>	\$7,760.00	\$7,760.00	
<b>Total:</b>	<b>\$22,045.00</b>	<b>\$25,980.00</b>	+hst

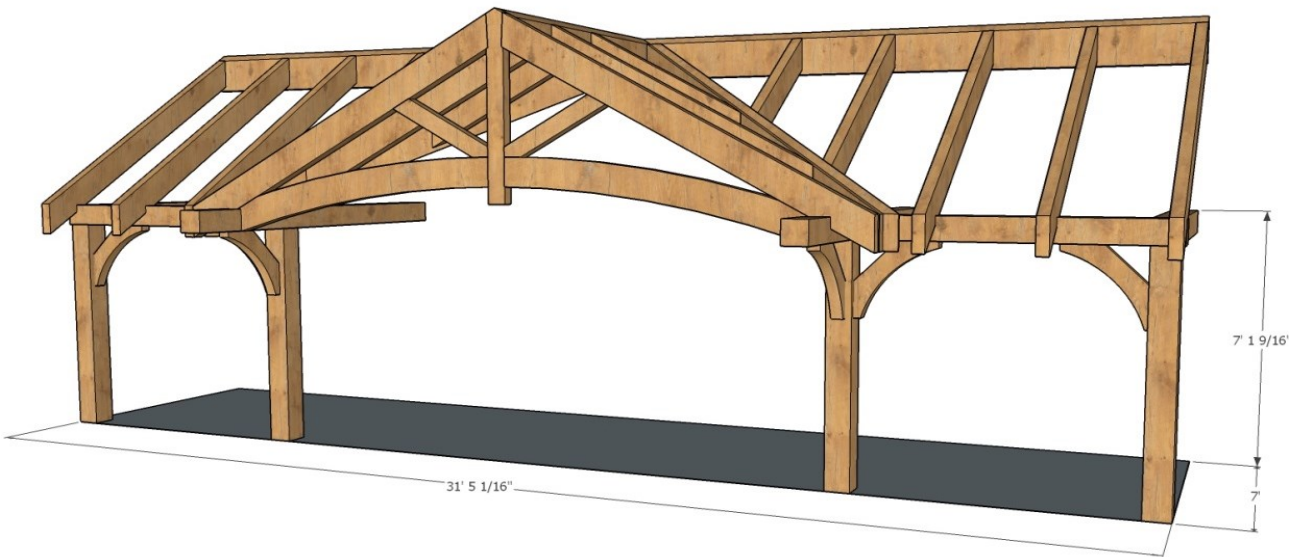

<u>Installed on the Ceiling:</u>	<u>\$4,740.00</u>	<u>\$5,130.00</u>	
<b>Total with Decking</b>	<b>\$26,785.00</b>	<b>\$31,110.00</b>	+hst

Details:

Sanding of timbers:	Yes
Clear oil based stain:	Yes
Engineering of timber work:	Yes
Timber frame footprint (sq.ft.)	220.0

\* Please contact us for current pricing.

31' x 7' Front Porch with King Truss\_2020sre.xlsx