

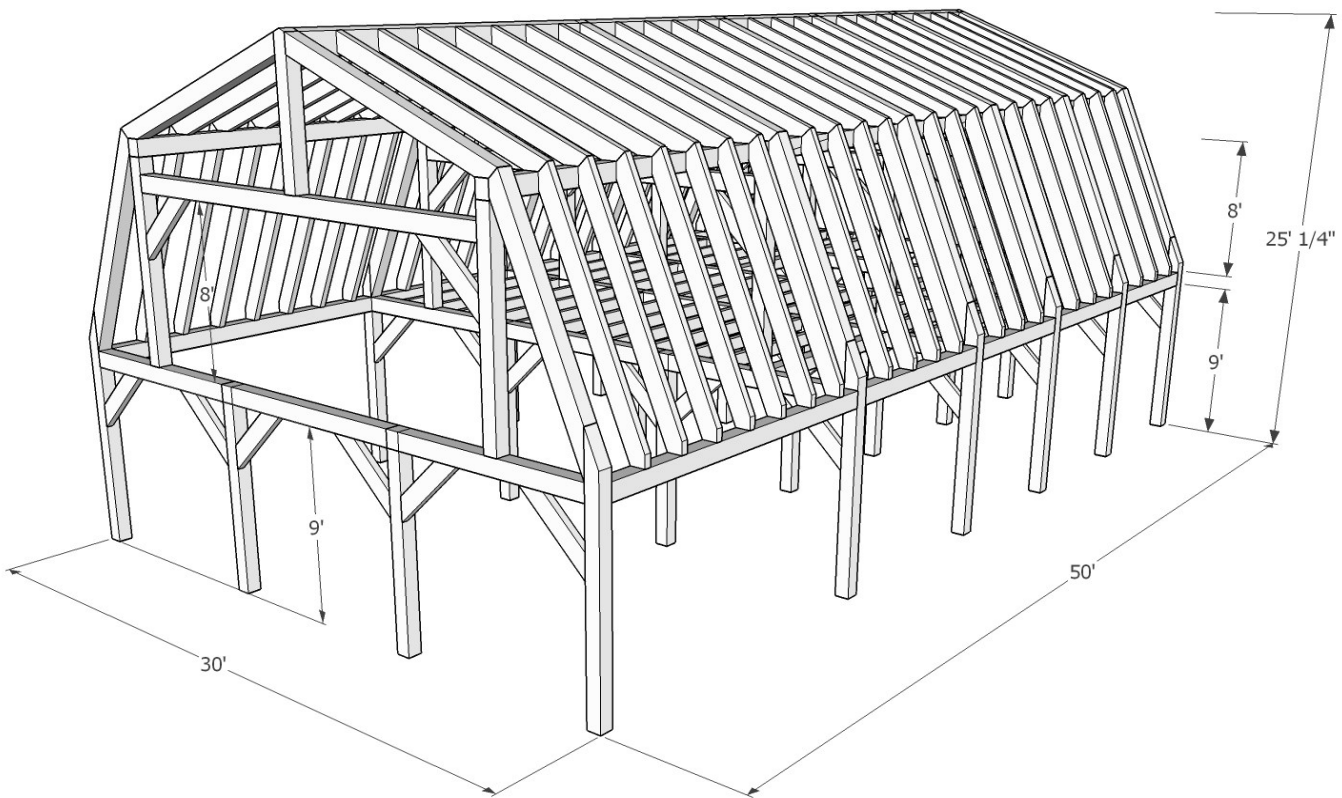

1948 Sharpe's Lane, Brockville, ON K6V 5T1
 Office: (613) 498-2406 / Cell: (613) 803-3241
www.gibson timber frames.com
info@gibson timber frames.com

Project: 30' x 50' Gambrel Barn w/ Loft
Location: Spencerville, ON
Original estimate date: February 2019

	<u><i>Eastern White Pine</i></u>	<u><i>Western Douglas Fir</i></u>	
<i>Shop Work & Design:</i>	\$86,005.00	\$121,975.00	
<u><i>Delivery & Installation:</i></u>	<u>\$44,195.00</u>	<u>\$44,195.00</u>	
<i>Total:</i>	<i>\$130,200.00</i>	<i>\$166,170.00</i>	+hst



Details:

Sanding of timbers:	No
Clear oil based stain:	No
Engineering of timber work:	Yes
Timber frame footprint (sq.ft.)	1,500.0
Total living space w/ loft (sq. ft.)	2,285.0

* Please contact us for current pricing.

30' x 50' Gambrel Barn with Lofts_2019sei.xlsx