



1948 Sharpe's Lane, Brockville, ON K6V 5T1

Office: (613) 498-2406 / Cell: (613) 803-3241

www.gibson timber frames.com

info@gibson timber frames.com

Project: 26' x 22' Gazebo w/ Arched King Post Trusses
Location: Brockville, ON
Original estimate date: October 2020

	<u><i>E. White Pine</i></u>	<u><i>W. Douglas Fir</i></u>	
<i>Shop Work & Design:</i>	\$34,740.00	\$44,555.00	
<u><i>Delivery & Installation:</i></u>	<u>\$12,220.00</u>	<u>\$12,220.00</u>	
<i>Total:</i>	\$46,960.00	\$56,775.00	+hst

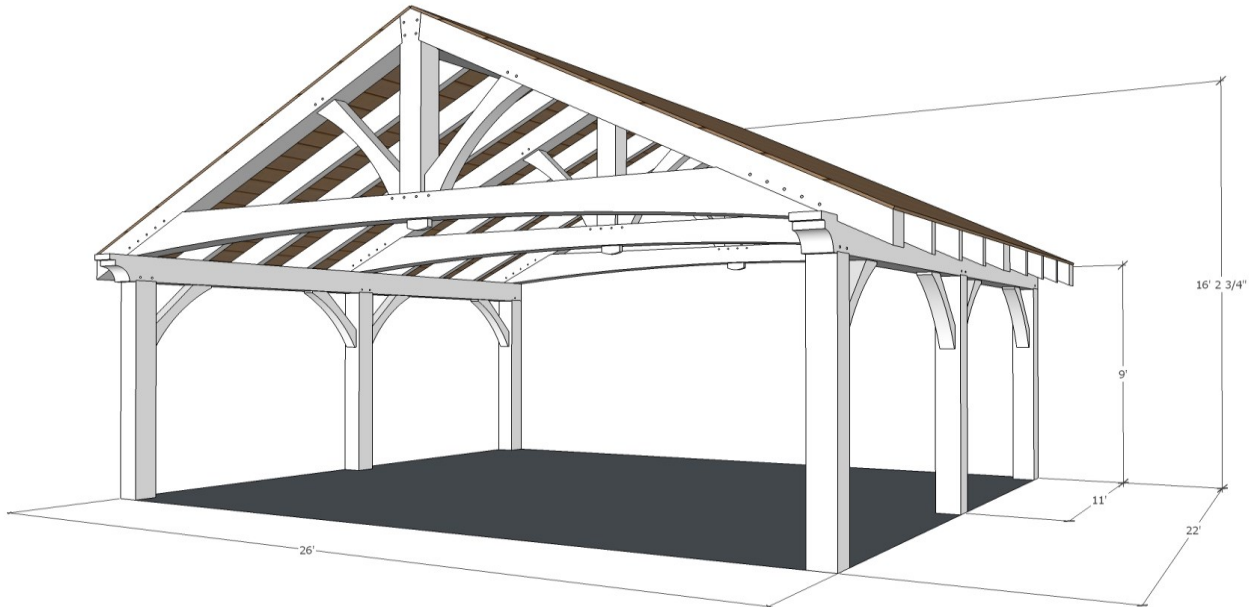

<u><i>Add decking installed on the ceiling:</i></u>	<u>\$10,425.00</u>	<u>\$10,580.00</u>	
<i>Total with Decking</i>	\$57,385.00	\$67,355.00	+hst

Details:

<i>Sanding of timbers:</i>	Yes
<i>Clear oil based stain:</i>	Yes
<i>Engineering of timber work:</i>	Yes
<i>Timber frame footprint (sq.ft.)</i>	572.0

* Please contact us for current pricing.

26' x 22' Gazebo Arched King Truss_2021eni.xlsx