

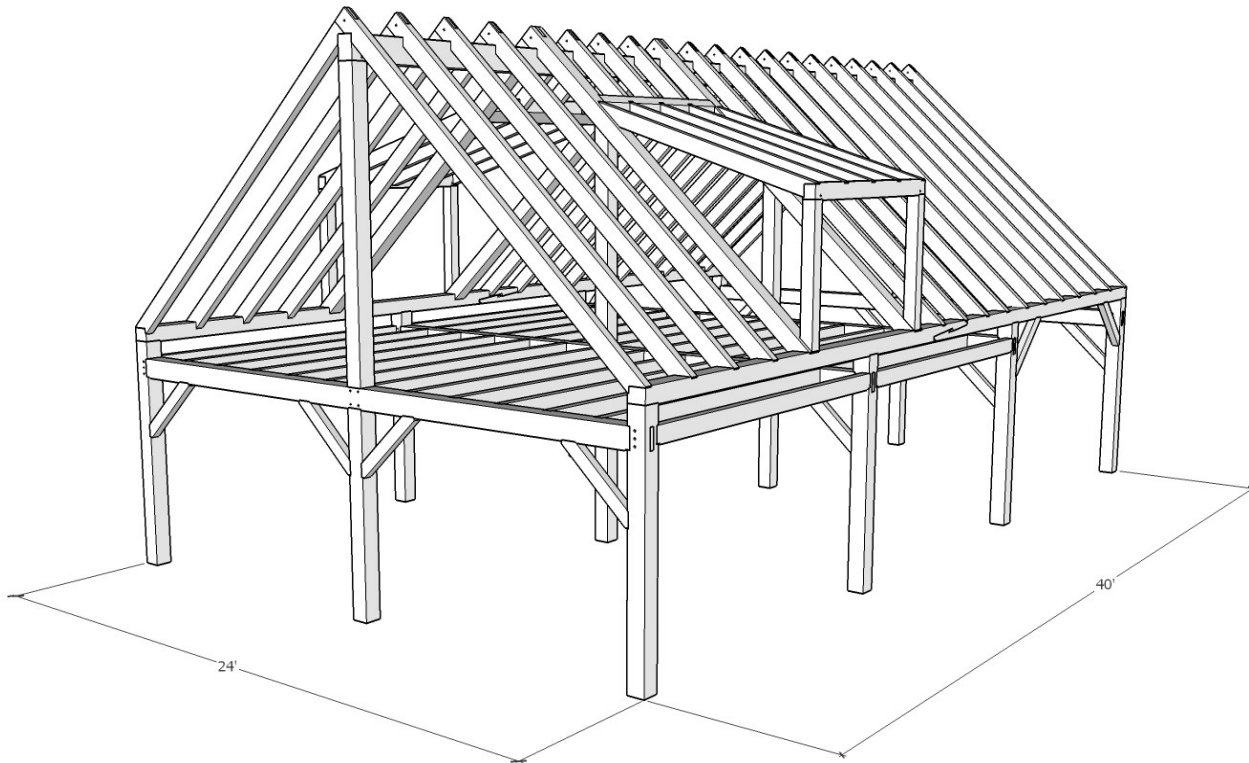

1948 Sharpe's Lane, Brockville, ON K6V 5T1
 Office: (613) 498-2406 / Cell: (613) 803-3241
www.gibson timber frames.com
info@gibson timber frames.com

Project: 24' x 40' Petworth w/ 2 Shed Dormers
Location: Guelph, ON
Original Estimate Date: October 2021

	<u><i>E. White Pine</i></u>	<u><i>Douglas Fir FoHC</i></u>	
<i>Shop Work & Design:</i>	\$49,885.00	\$63,125.00	
<u><i>Delivery & Installation:</i></u>	<u>\$26,995.00</u>	<u>\$26,995.00</u>	
<i>Total:</i>	<i>\$76,880.00</i>	<i>\$90,120.00</i>	<i>+hst</i>



<u><i>Details:</i></u>	
<i>Sanding of timbers:</i>	Yes
<i>Clear oil based stain:</i>	Yes
<i>Engineering of timber work:</i>	Yes
<i>Timber frame footprint (sq. ft.)</i>	960.0
<i>Total living space w/ loft (sq. ft.)</i>	1,565.0

* Please contact us for current pricing.