

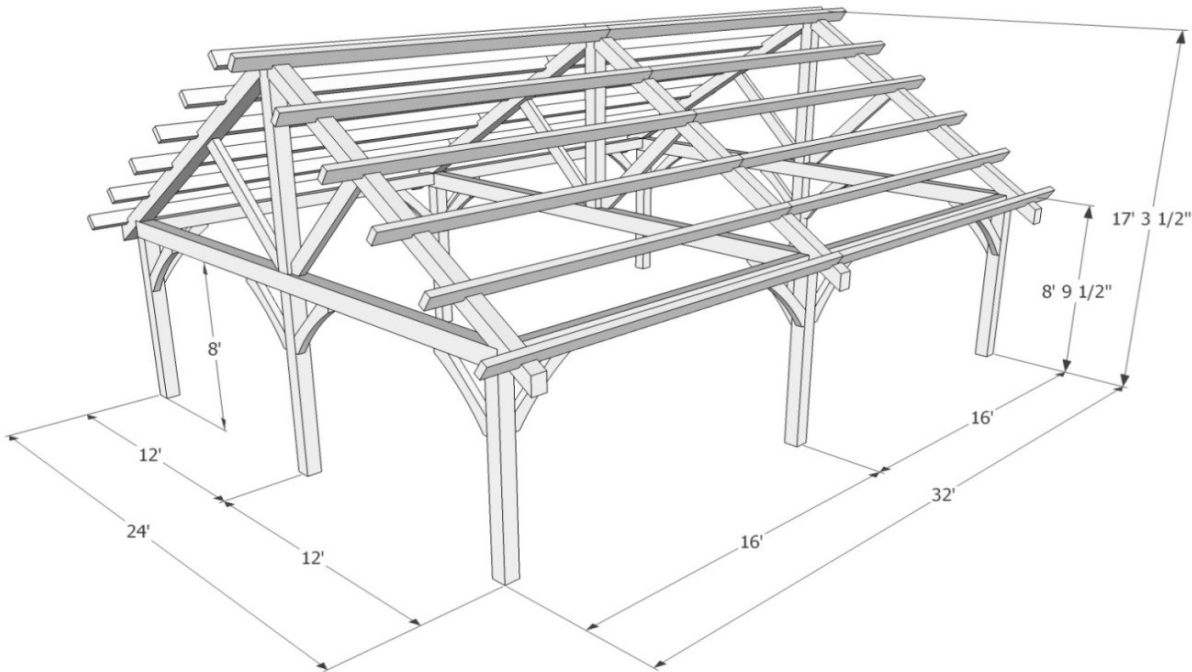

1948 Sharpe's Lane, Brockville, ON K6V 5T1  
 Office: (613) 498-2406 / Cell: (613) 803-3241  
[www.gibson timber frames.com](http://www.gibson timber frames.com)  
[info@gibson timber frames.com](mailto:info@gibson timber frames.com)

**Project:** 24' x 32' Gazebo w/ King Post Trusses  
**Location:** Plantagenet, ON  
**Original estimate date:** May 2020

	<u><b>Eastern White Pine</b></u>	<u><b>Douglas Fir FoH</b></u>	
<i>Shop Work &amp; Design:</i>	\$26,695.00	\$33,955.00	
<i><u>Delivery &amp; Installation:</u></i>	<u>\$14,505.00</u>	<u>\$14,505.00</u>	
<b>Total:</b>	<b>\$41,200.00</b>	<b>\$48,460.00</b>	+hst



<i><u>Decking installed on the ceilings:</u></i>	<u>\$11,795.00</u>	<u>\$13,090.00</u>	
<b>Total with Decking:</b>	<b>\$52,995.00</b>	<b>\$61,550.00</b>	+hst

<u><b>Details:</b></u>	
Sanding of timbers:	Yes
Clear oil based stain:	Yes
Engineering of timber work:	Yes
Timber frame footprint (sq.ft.)	768.0

\* Please contact us for current pricing.