



1948 Sharpe's Lane, Brockville, ON K6V 5T1
 Office: (613) 498-2406 / Cell: (613) 803-3241

www.gibson timber frames.com
info@gibson timber frames.com

Project: 20' x 30' Gambrel Barn w/ Shed Dormer
Location: Frontenac County, ON
Original estimate date: December 2016

	<u>Eastern White Pine</u>	<u>Western Douglas Fir</u>	
Shop Work & Design:	\$29,990.00	\$36,425.00	
Delivery & Installation:	\$15,760.00	\$15,760.00	
Total:	\$45,750.00	\$52,185.00	+hst

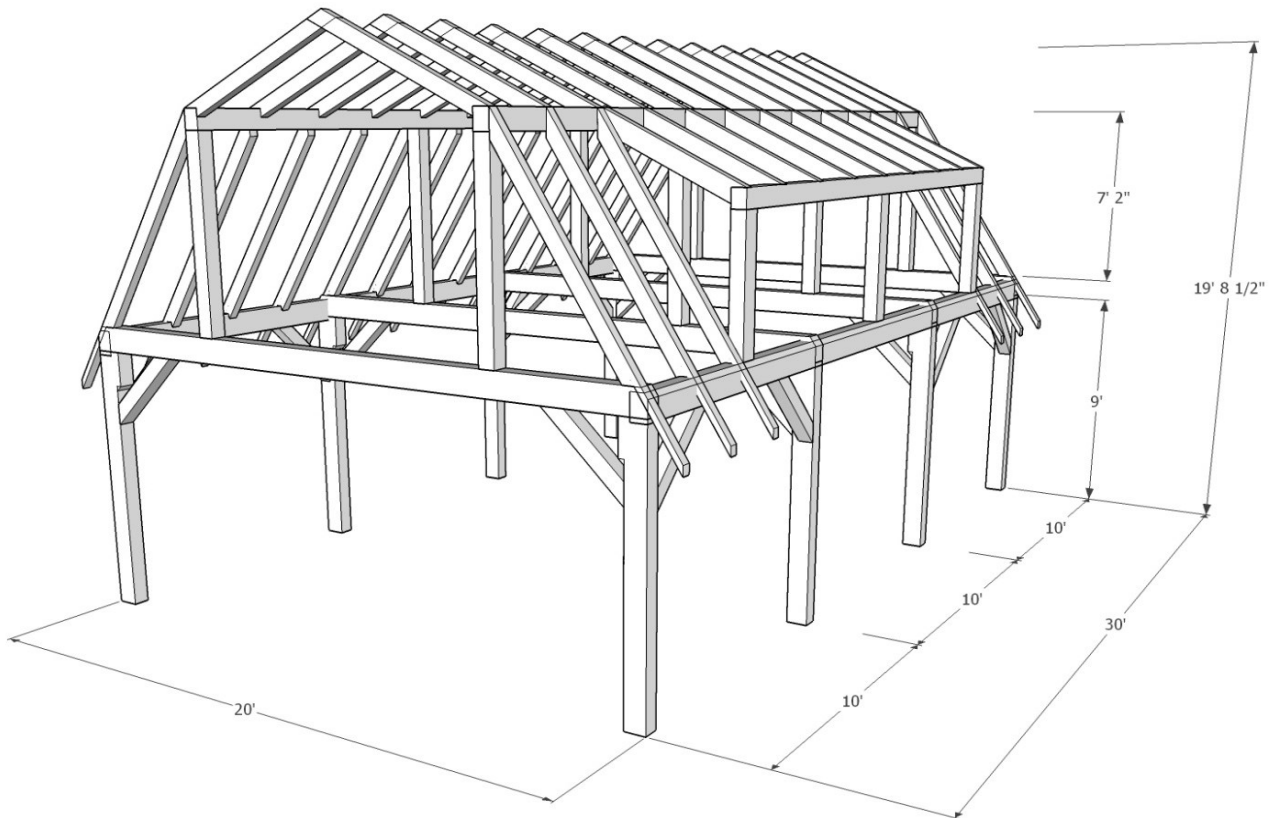

Details:

Sanding of timbers:	Yes
Clear oil based stain:	Yes
Engineering of timber work:	Yes
Timber frame footprint (sq.ft.)	600.0

* Please contact us for current pricing.