

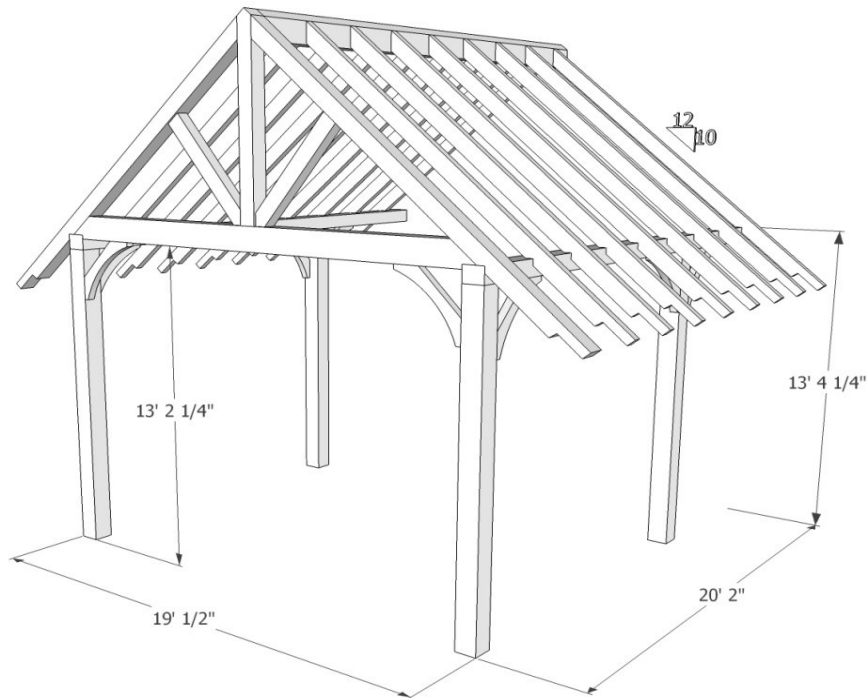

1948 Sharpe's Lane, Brockville, ON K6V 5T1
 Office: (613) 498-2406 / Cell: (613) 803-3241
www.gibson timber frames.com
info@gibson timber frames.com

Project: 19' x 20' Lanai w/ King Post Trusses
Location: Perth, ON
Original estimate date: January 2019

	<u><i>E. White Pine</i></u>	<u><i>W. Douglas Fir</i></u>	
<i>Shop Work & Design:</i>	\$17,880.00	\$23,565.00	
<u><i>Delivery & Installation:</i></u>	<u>\$9,410.00</u>	<u>\$9,410.00</u>	
Total:	\$27,290.00	\$32,975.00	+hst



<u><i>Decking installed on the ceilings:</i></u>	<u>\$7,580.00</u>	<u>\$8,410.00</u>	
Total with Decking:	\$34,870.00	\$41,385.00	+hst

Details:

Sanding of timbers:	Yes
Clear oil based stain:	Yes
Engineering of timber work:	Yes
Timber frame footprint (sq.ft.)	384.0

* Please contact us for current pricing.