



1948 Sharpe's Lane, Brockville, ON K6V 5T1  
Office: (613) 498-2406 / Cell: (613) 803-3241

[www.gibson timber frames.com](http://www.gibson timber frames.com)

[info@gibson timber frames.com](mailto:info@gibson timber frames.com)

**Project:** 16' x 34' Barn w/ King Trusses  
**Location:** Prince Edward County, ON  
**Original estimate date:** August 2021

	<u><i>E. White Pine</i></u>	<u><i>Douglas Fir FoHC</i></u>	
<i>Shop Work &amp; Design:</i>	\$46,315.00	\$55,670.00	
<i>Delivery &amp; Installation:</i>	\$20,800.00	\$20,800.00	
<b>Total:</b>	<b>\$67,115.00</b>	<b>\$76,470.00</b>	+hst

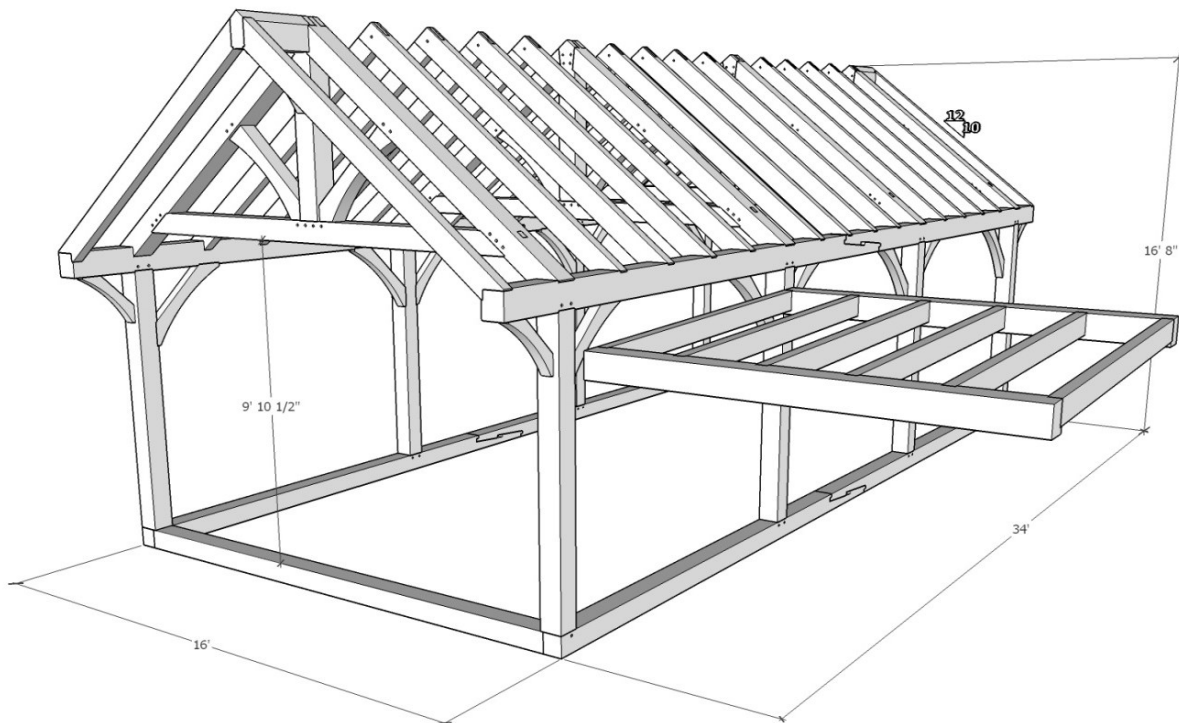

<u><i>Add decking installed on the ceiling:</i></u>	<u>\$14,525.00</u>	<u>\$17,660.00</u>	
<b>Total with Decking</b>	<b>\$81,640.00</b>	<b>\$94,130.00</b>	+hst

**Details:**

Sanding of timbers:	Yes
Clear oil based stain:	Yes
Engineering of timber work:	Yes
Timber frame footprint (sq. ft.)	544.0

\* Please contact us for current pricing.

16' x 34' Barn w King Trusses\_2021tsi.xlsx