



1948 Sharpe's Lane, Brockville, ON K6V 5T1

Office: (613) 498-2406 / Cell: (613) 803-3241

www.gibson timber frames.cominfo@gibson timber frames.com

Project: 16' - 6" x 24' Three Season Screened Addition
 Location: Athens, ON
 Original estimate date: April 14, 2020

	<u>Eastern White Pine</u>	<u>Douglas Fir FoH</u>	
Shop Work & Design:	\$20,510.00	\$26,325.00	
<u>Delivery & Installation:</u>	<u>\$11,380.00</u>	<u>\$11,380.00</u>	
Total:	\$31,890.00	\$37,705.00	+hst

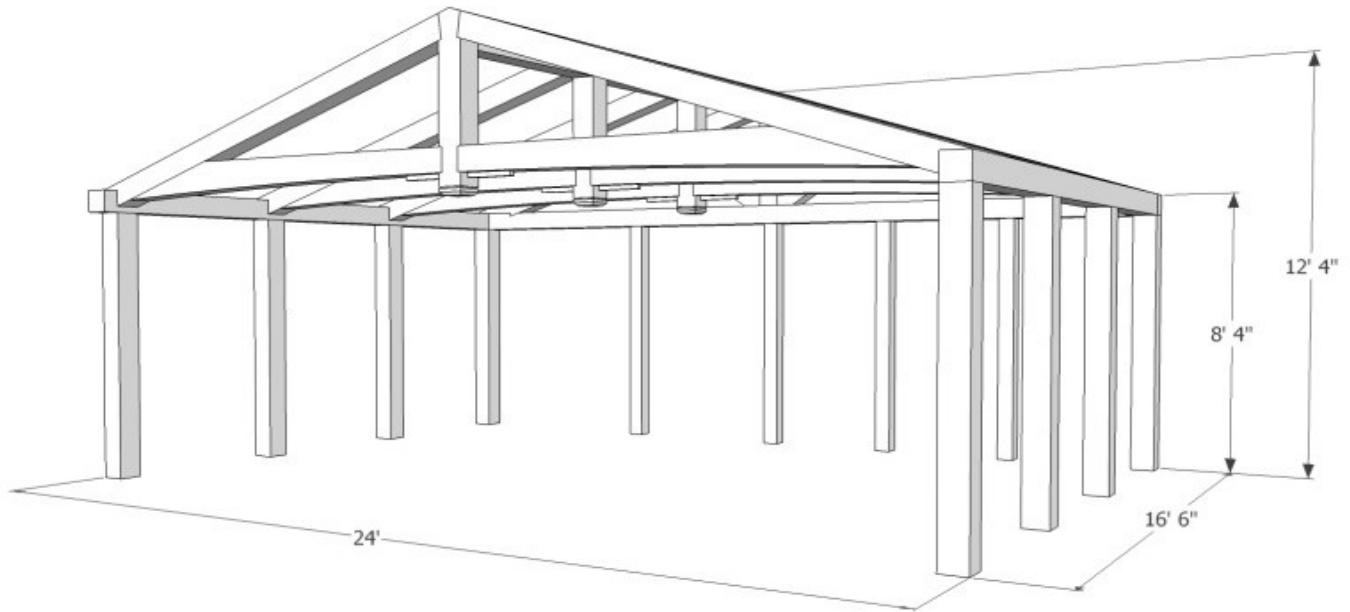

<u>Decking installed on the ceilings:</u>	<u>\$4,620.00</u>	<u>\$5,125.00</u>	
Total with Decking:	\$36,510.00	\$42,830.00	+hst

Details:

Sanding of timbers:	Yes
Clear oil based stain:	Yes
Engineering of timber work:	Yes
Timber frame footprint (sq.ft.)	396.0

* Please contact us for current pricing.

16' - 6in x 24' Three Season Room_2020kuh.xlsx