

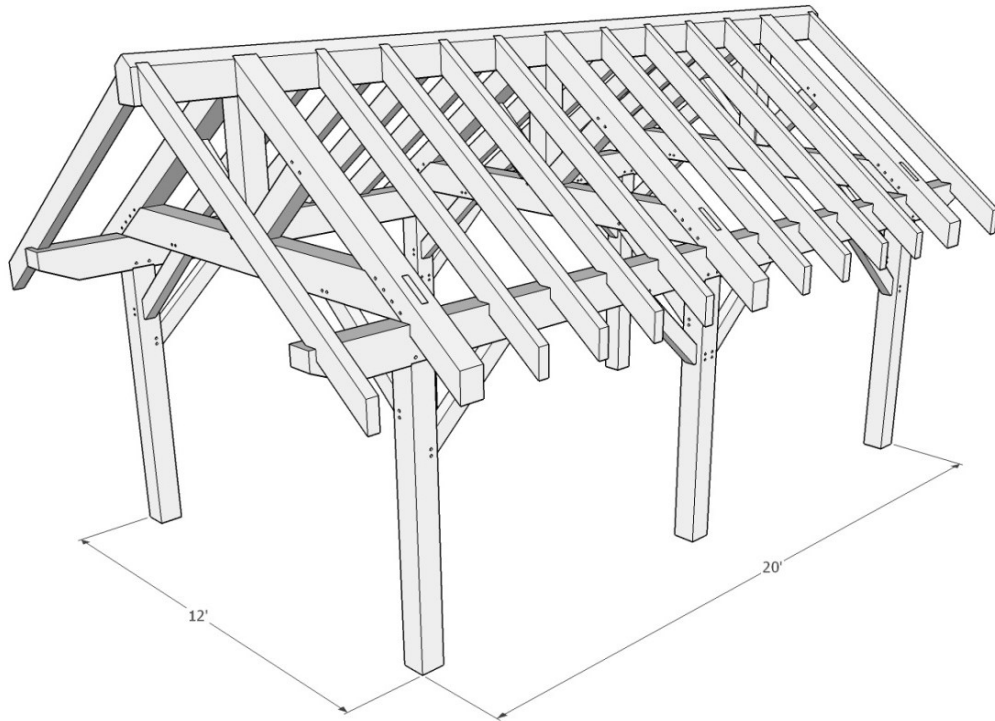

1948 Sharpe's Lane, Brockville, ON K6V 5T1
 Office: (613) 498-2406 / Cell: (613) 803-3241
www.gibson timber frames.com
info@gibson timber frames.com

Project: 12' x 20' Gazebo w/ King Post Trusses
Location: Ottawa South
Original estimate date: May 2021

	<u><i>E. White Pine</i></u>	<u><i>W. Douglas Fir</i></u>	
<i>Shop Work & Design</i>	\$21,300.00	\$26,620.00	
<u><i>Delivery & Installation:</i></u>	<u>\$8,750.00</u>	<u>\$8,750.00</u>	
Total:	\$30,050.00	\$35,370.00	+hst



<u><i>Supply Only - Stained T&G decking:</i></u>	<u>\$3,630.00</u>	<u>\$3,745.00</u>	
Total with Decking	\$33,680.00	\$39,115.00	+hst

<u><i>Details:</i></u>	
<i>Sanding of timbers:</i>	Yes
<i>Clear oil based stain:</i>	Yes
<i>Engineering of timber work:</i>	Yes
<i>Timber frame footprint (sq.ft.)</i>	240.0

* Please contact us for current pricing.