

The HUDSON BARN

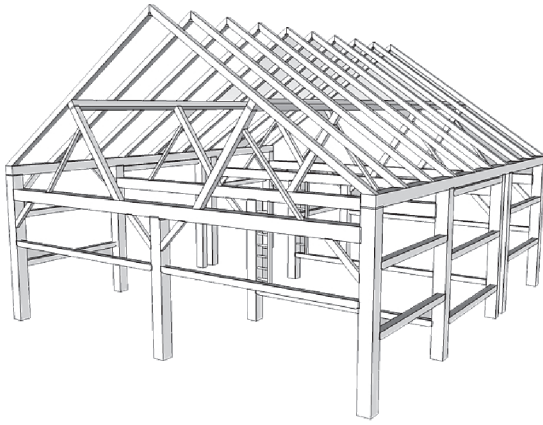

PERSPECTIVE

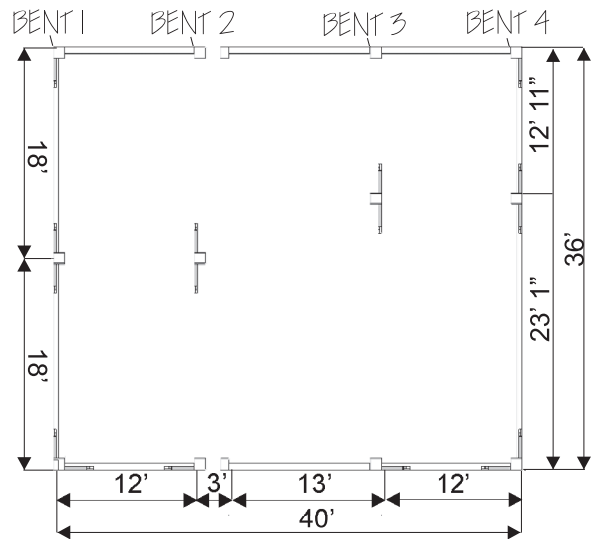

FLOOR PLAN

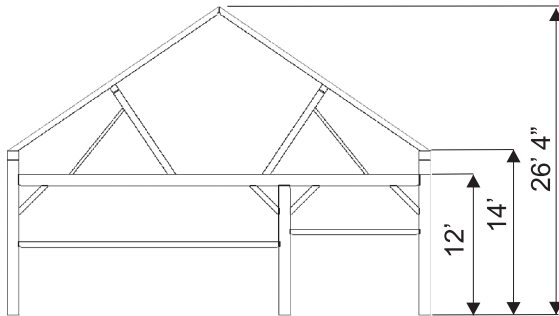

BENT VIEW

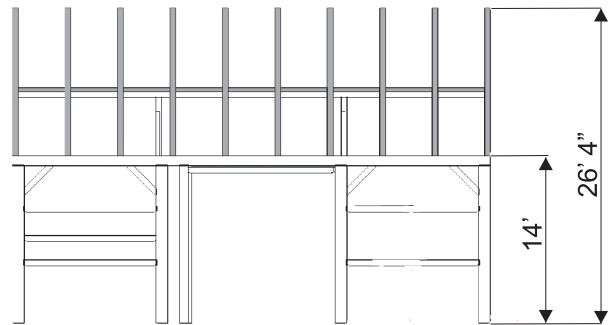

SIDE VIEW

This 36 x 40 barn was most likely built in the mid 1800's and is a canted queen post style. This meaning the upstairs posts are tipped on an angle to catch the rafter load and transfer the load through the frame and into the foundation. Large hand hewn timbers, pole rafters, and a built in ladder are some unique features of this frame.

